

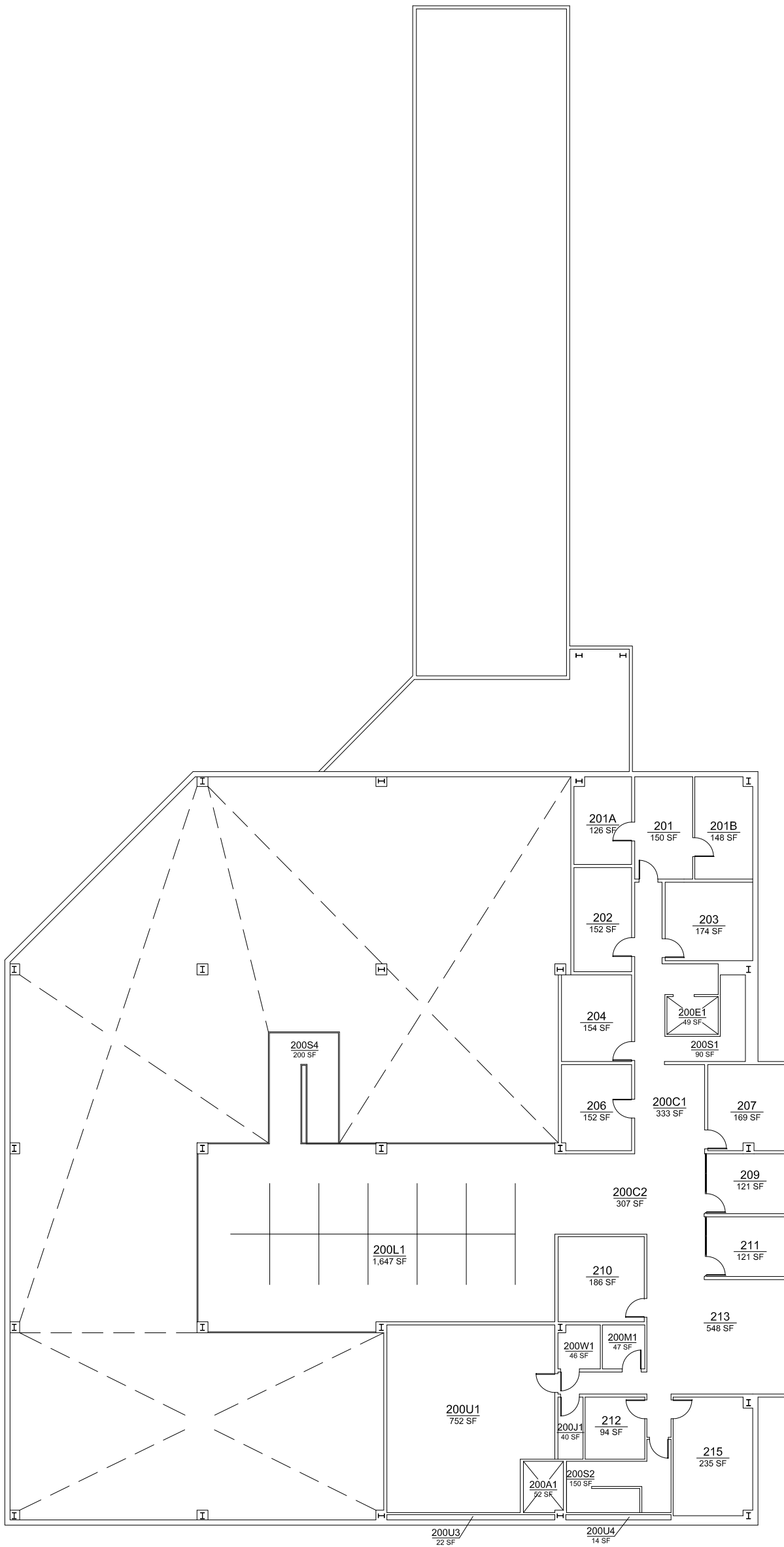

Rotation 18°45'36" NW



Facilities Planning
& Construction
3300 Seawolf Drive, Suite 106
Anchorage, AK 99508
UNIVERSITY of ALASKA ANCHORAGE

Updated By:	D.R.F.
Date Updated:	02.23.23
Printed By:	D.R.F.
Date Printed:	02.23.23
Scale:	1" = 20'
Sheet 3 of 3 Sheets	

ENROLLMENT SERVICES CENTER
SECOND FLOOR
BUILDING NO.: AS118

ANCHORAGE MAIN CAMPUS
2901 SPIRIT WAY
ANCHORAGE, ALASKA 99508